



**HESTORE.HU**

elektronikai alkatrész áruház

**EN:** This Datasheet is presented by the manufacturer.

Please visit our website for pricing and availability at [www.hestore.hu](http://www.hestore.hu).

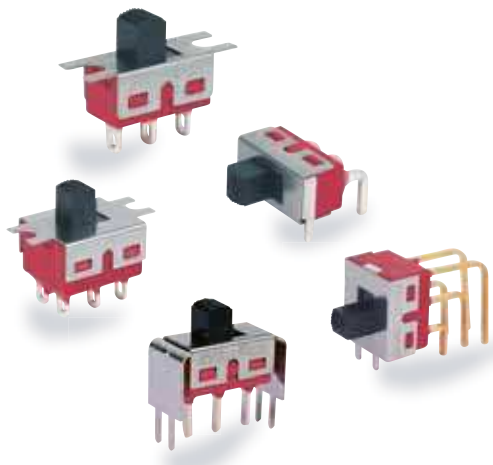

## SPECIFICATIONS

- CONTACT RATING:** Dependent upon contact material.
- MECHANICAL LIFE:** 30,000 make-and-break cycles.
- CONTACT RESISTANCE:** 10mΩ max. initial @ 2-4VDC  
100mA for both silver and gold plated contacts.
- INSULATION RESISTANCE:** 1,000MΩ min.
- DIELECTRIC STRENGTH:** 1,000 V RMS@sea level.
- OPERATING TEMPERATURE:** -30°C to 85°C.

## MATERIALS

- CASE:** Diallyl phthalate (DAP) (UL94v-0).
- HOUSING:** Stainless Steel.
- ACTUATOR:** Nylon, black std.
- CONTACT:** Silver or gold plated.
- TERMINAL SEAL:** Epoxy. (See Page 92)

## HOW TO ORDER

Slide Switches

MODEL NO.	ACTUATOR	ACTUATOR COLOR	MOUNTING EARS	TERMINATIONS	CONTACT MATERIAL	SEAL	ROHS SOLDERING																																																																																						
		<b>See below</b>																																																																																											
<table border="0" style="width: 100%;"> <tr><td>MODEL NO.</td><td></td></tr> <tr><td>5MS1</td><td>SP On-None-On</td></tr> <tr><td>5MS2</td><td>SP On-None-Mom</td></tr> <tr><td>5MS3</td><td>SP On-Off-On</td></tr> <tr><td>5MD1</td><td>DP On-None-On</td></tr> <tr><td>5MD3</td><td>DP On-Off -On</td></tr> </table>	MODEL NO.		5MS1	SP On-None-On	5MS2	SP On-None-Mom	5MS3	SP On-Off-On	5MD1	DP On-None-On	5MD3	DP On-Off -On	<table border="0" style="width: 100%;"> <tr><td>ACTUATOR</td><td></td></tr> <tr><td>S0</td><td>1.30 high</td></tr> <tr><td>S1</td><td>5.08 high</td></tr> <tr><td>S2</td><td>7.24 high</td></tr> <tr><td>S3</td><td>9.40 high</td></tr> <tr><td>S4</td><td>3.56 high</td></tr> <tr><td>S5</td><td>5.08 high</td></tr> <tr><td>S7</td><td>12.32 high</td></tr> </table>	ACTUATOR		S0	1.30 high	S1	5.08 high	S2	7.24 high	S3	9.40 high	S4	3.56 high	S5	5.08 high	S7	12.32 high	<table border="0" style="width: 100%;"> <tr><td>ACTUATOR COLOR</td><td></td></tr> <tr><td colspan="2" style="text-align: center;"><b>See below</b></td></tr> </table>	ACTUATOR COLOR		<b>See below</b>		<table border="0" style="width: 100%;"> <tr><td>MOUNTING EARS</td><td></td></tr> <tr><td>A</td><td>NO Mounting Ears</td></tr> <tr><td>B</td><td>Mounting Ears</td></tr> </table>	MOUNTING EARS		A	NO Mounting Ears	B	Mounting Ears	<table border="0" style="width: 100%;"> <tr><td>TERMINATIONS</td><td></td></tr> <tr><td>M1</td><td>Solder Lug</td></tr> <tr><td>M2</td><td>PC thru-hole</td></tr> <tr><td>M3</td><td>Quick Connect</td></tr> <tr><td>M5-1</td><td>18.70 high, wire wrap</td></tr> <tr><td>M5-2</td><td>24.20 high, wire wrap</td></tr> <tr><td>M5-3</td><td>10.55 high, wire wrap</td></tr> <tr><td>M5-4</td><td>26.97 high, wire wrap</td></tr> <tr><td>M6</td><td>Right angle, PC thru-hole</td></tr> <tr><td>M7</td><td>Vertical right angle, PC thru-hole</td></tr> <tr><td>VS2</td><td>V-bracket</td></tr> </table>	TERMINATIONS		M1	Solder Lug	M2	PC thru-hole	M3	Quick Connect	M5-1	18.70 high, wire wrap	M5-2	24.20 high, wire wrap	M5-3	10.55 high, wire wrap	M5-4	26.97 high, wire wrap	M6	Right angle, PC thru-hole	M7	Vertical right angle, PC thru-hole	VS2	V-bracket	<table border="0" style="width: 100%;"> <tr><td>CONTACT MATERIAL</td><td></td></tr> <tr><td>Q</td><td>Silver</td></tr> <tr><td>R</td><td>Gold</td></tr> <tr><td>G</td><td>Gold,pure-tin</td></tr> <tr><td>S</td><td>Silver,pure-tin</td></tr> <tr><td>C</td><td>Gold over silver</td></tr> <tr><td>K</td><td>Gold over silver,pure-tin</td></tr> </table>	CONTACT MATERIAL		Q	Silver	R	Gold	G	Gold,pure-tin	S	Silver,pure-tin	C	Gold over silver	K	Gold over silver,pure-tin	<table border="0" style="width: 100%;"> <tr><td>SEAL</td><td></td></tr> <tr><td>E</td><td>EPOXY (std)</td></tr> <tr><td>N</td><td>NO EPOXY</td></tr> </table>	SEAL		E	EPOXY (std)	N	NO EPOXY	<table border="0" style="width: 100%;"> <tr><td>ROHS SOLDERING</td><td></td></tr> <tr><td>□</td><td>Rohs Compliant</td></tr> <tr><td>S</td><td>Rohs &amp; Lead Free</td></tr> </table>	ROHS SOLDERING		□	Rohs Compliant	S	Rohs & Lead Free
MODEL NO.																																																																																													
5MS1	SP On-None-On																																																																																												
5MS2	SP On-None-Mom																																																																																												
5MS3	SP On-Off-On																																																																																												
5MD1	DP On-None-On																																																																																												
5MD3	DP On-Off -On																																																																																												
ACTUATOR																																																																																													
S0	1.30 high																																																																																												
S1	5.08 high																																																																																												
S2	7.24 high																																																																																												
S3	9.40 high																																																																																												
S4	3.56 high																																																																																												
S5	5.08 high																																																																																												
S7	12.32 high																																																																																												
ACTUATOR COLOR																																																																																													
<b>See below</b>																																																																																													
MOUNTING EARS																																																																																													
A	NO Mounting Ears																																																																																												
B	Mounting Ears																																																																																												
TERMINATIONS																																																																																													
M1	Solder Lug																																																																																												
M2	PC thru-hole																																																																																												
M3	Quick Connect																																																																																												
M5-1	18.70 high, wire wrap																																																																																												
M5-2	24.20 high, wire wrap																																																																																												
M5-3	10.55 high, wire wrap																																																																																												
M5-4	26.97 high, wire wrap																																																																																												
M6	Right angle, PC thru-hole																																																																																												
M7	Vertical right angle, PC thru-hole																																																																																												
VS2	V-bracket																																																																																												
CONTACT MATERIAL																																																																																													
Q	Silver																																																																																												
R	Gold																																																																																												
G	Gold,pure-tin																																																																																												
S	Silver,pure-tin																																																																																												
C	Gold over silver																																																																																												
K	Gold over silver,pure-tin																																																																																												
SEAL																																																																																													
E	EPOXY (std)																																																																																												
N	NO EPOXY																																																																																												
ROHS SOLDERING																																																																																													
□	Rohs Compliant																																																																																												
S	Rohs & Lead Free																																																																																												

ITEM NO	COLOR
1	White
2	Black (Std)
3	Red
4	Orange
5	Yellow
6	Green
7	Blue
8	Brown
9	Gray

# SWITCH FUNCTION

NO. POLES	UL/CSA MODEL NO.	MODEL NO.	SWITCH FUNCTION			CONNECTED TERMINALS / SCHEMATIC		
			POS.1	POS.2	POS.3	POS.1	POS.2	POS.3
SP	Q1511	5MS1	ON	NONE	ON	2-1	N/A	2-3
	Q1512	5MS2	ON	NONE	MOM			
	Q1513	5MS3	ON	OFF	ON			OPEN
DP	Q1521	5MD1	ON	NONE	ON	2-1,5-4	N/A	2-3,5-6
	Q1523	5MD3	ON	OFF	ON			
OPEN								

MOM=MOMENTARY

# POLE OPTIONS

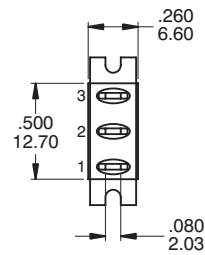
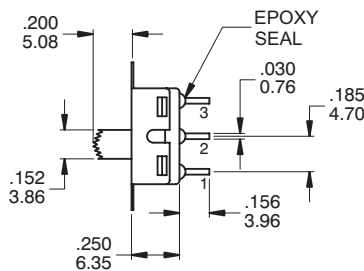
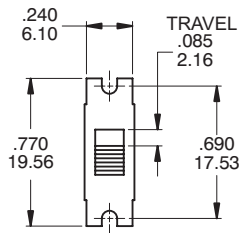
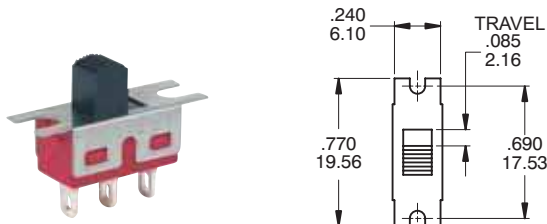

SPDT

Part No. Shown : 5MS1S12BM1QE

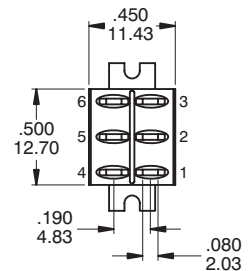
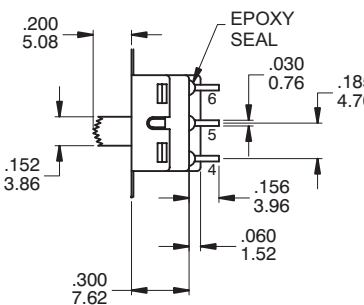
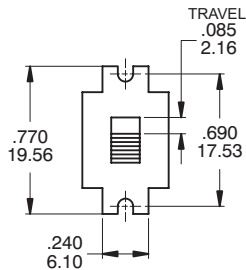
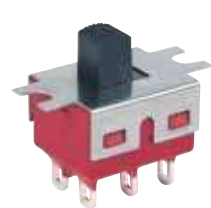

DPDT

Part No. Shown : 5MD1S12BM1QE

# ACTUATOR OPTIONS

S1 STD

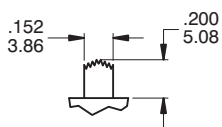

S2

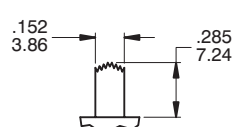

S0

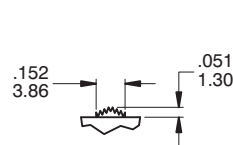

FRONT

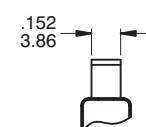

For S0,S1,S2,S3,S4

▲ S5

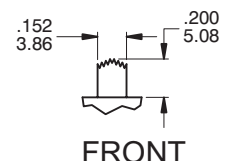

FRONT

S3

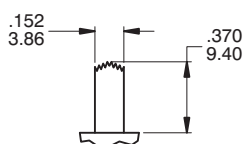

S4

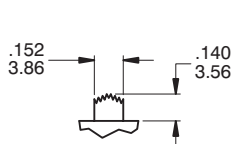

S7

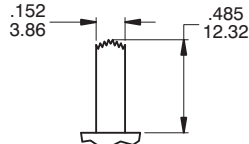

\* Subtract .014(0.36) from Actuator height for M6, M7 P.C. MOUNTING OPTION.

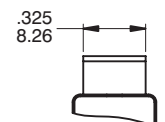

FOR DPDT ONLY

**TERMINATION OPTIONS**

**M1 SOLDER LUG**

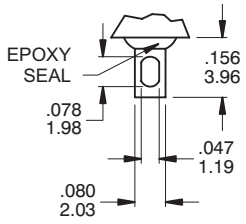

**M2 PC THRU-HOLE**

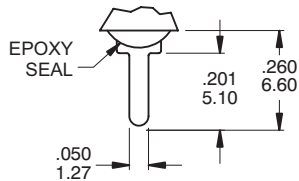

.030(0.76) THK.

**M3 QUICK CONNECT**

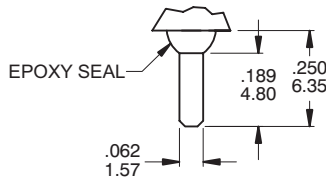

THK .030(0.76)

**M5 WIRE WRAP**

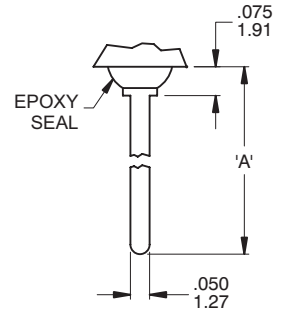

THK .030(0.76)

**OTHER TERMINATION OPTIONS**

- M6 RIGHT ANGLE P.C. MOUNT
- M7 RIGHT ANGLE P.C. MOUNT
- VS2 VERTICAL BRACKET P.C. MOUNT

RE Mating Quick Connector  
Amp P/N 60900-1

OPTION CODE	DIM. 'A'
M5-1	.736 (18.70)
M5-2	.953 (24.20)
M5-3	.415 (10.55)
M5-4	1.062 (26.97)

Slide Switches

**M6**

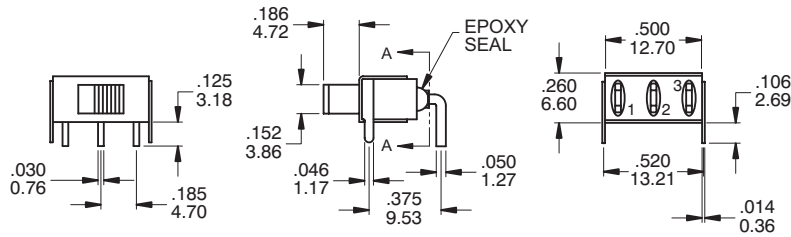

SECTION A-A  
TERM.NOS.FOR  
REFERENCE ONLY

P.C. MOUNTING

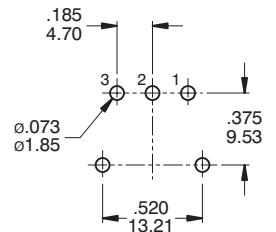

**SPDT**

Part No. Shown : 5MS1S12AM6QE

**M6**

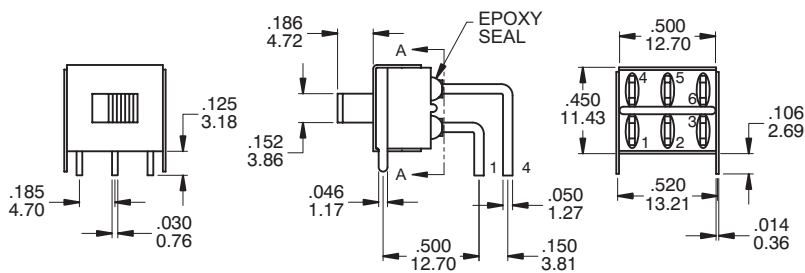

SECTION A-A  
TERM.NOS.FOR  
REFERENCE ONLY

P.C. MOUNTING

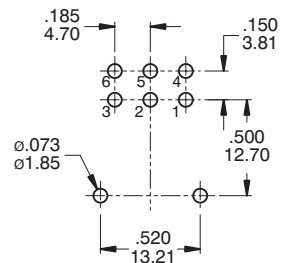

**DPDT**

Part No. Shown : 5MD1S12AM6QE

**M7**

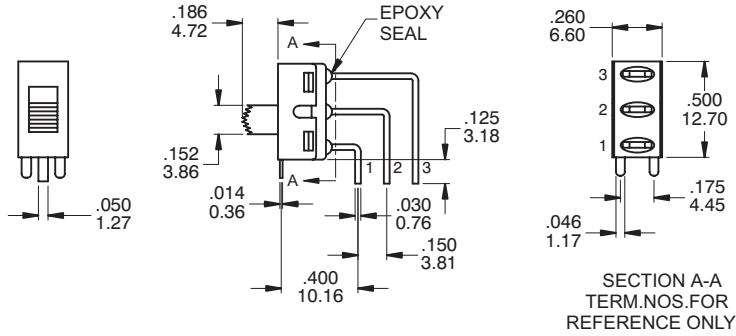

P.C. MOUNTING

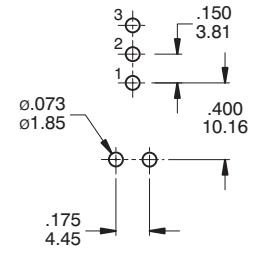

**SPDT**

Part No. Shown : 5MS1S12AM7QE

**M7**

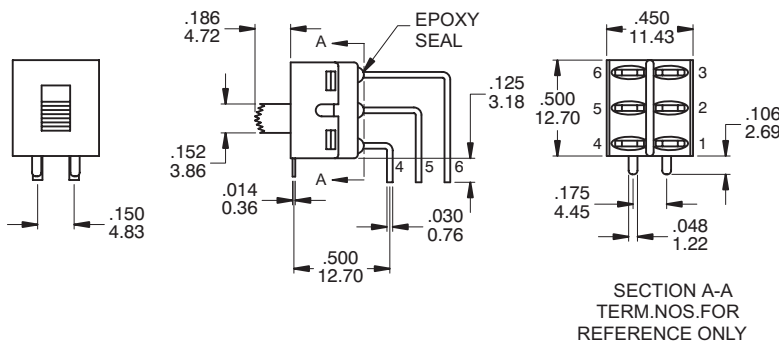

P.C. MOUNTING

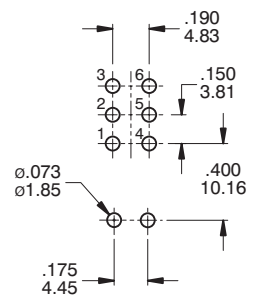

**DPDT**

Part No. Shown : 5MD1S12AM7RE

**VS2**

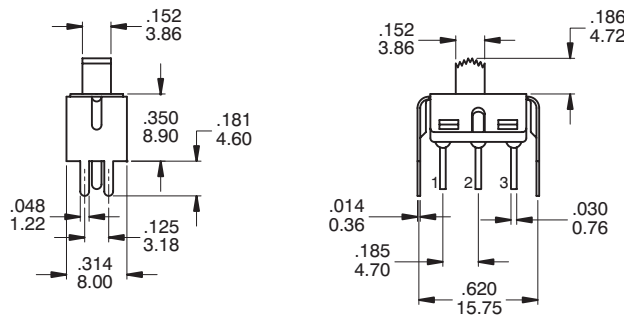
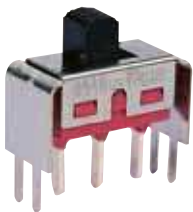

P.C. MOUNTING

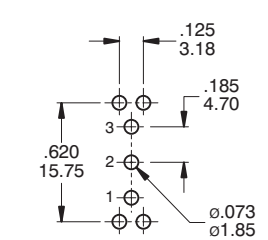

**SPDT**

Part No. Shown : 5MS1S12AVS2QE

**VS2**

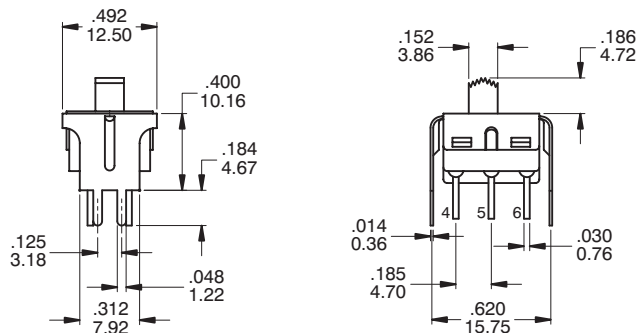
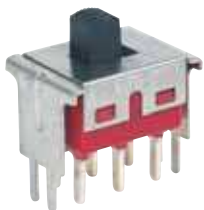

P.C. MOUNTING

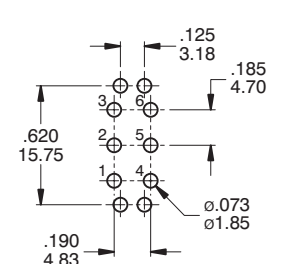

**DPDT**

Part No. Shown : 5MD1S12AVS2QE

**MOUNTING EARS / PANEL MOUNTING**

**MOUNTING EARS**

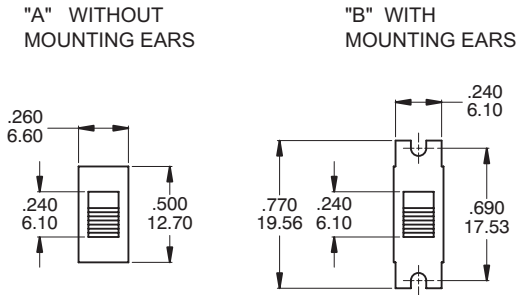

**PANEL MOUNTING**

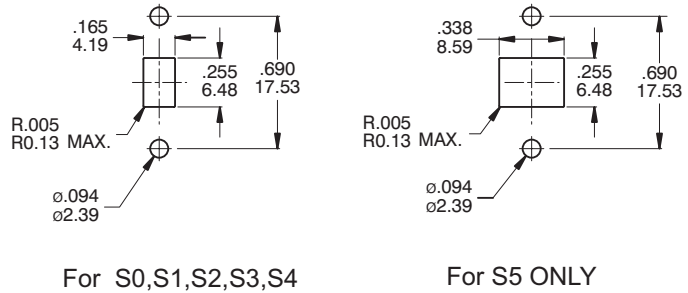

**THREE POSITIONS ONLY**

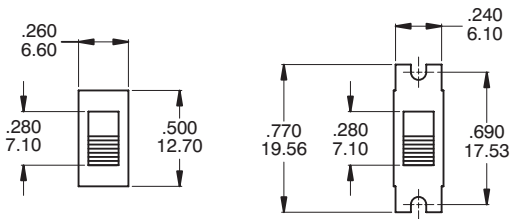

**THREE POSITIONS ONLY**

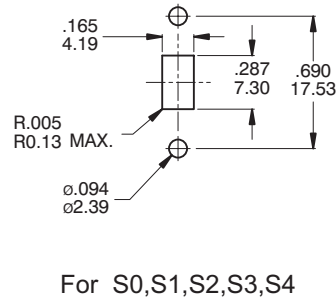

Slide Switches

**CONTACT MATERIAL OPTIONS**

	CONTACT MATERIAL	TERMINAL PLATING	RATINGS
<b>Q</b>	Silver	Q = Silver	5 Amps with resistant load @ 120VAC or 28VDC 2 Amps with resistant load @ 250VA
<b>S</b>		S = Silver,pure - tin	
<b>C</b>	Gold over Silver	C = Gold over silver	
<b>K</b>		K = Gold over silver,pure - tin	
<b>R</b>	Gold	R = Gold	0.4 Volt - Amps ( VA ) max. @ 20V max. ( AC or DC )
<b>G</b>		G = Gold,pure - tin	



**SOLDERING PROCESSES**

MANUAL SOLDERING : Use soldering iron of 30 watts, controlled st 350°C approximately 5 seconds while applying solder.

WAVE SOLDERING : Recommended Soldering Temperature : 260 ± 5°C  
 Duration of Solder Immersion : 5 ± 1 seconds  
 (PCB is 1.6mm in thickness)

**SOLDERING : Vapor phase**

