



HESTORE.HU

elektronikai alkatrész áruház

EN: This Datasheet is presented by the manufacturer.

Please visit our website for pricing and availability at www.hestore.hu.

REV.	DATE	DESCRIPTION
A	01/07/04	REFORMAT DRAWING

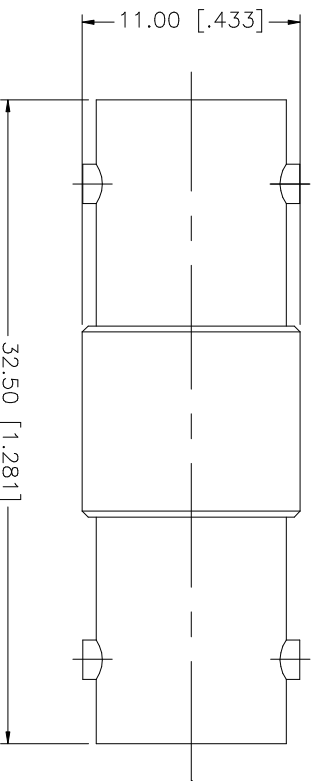

QTY	FINISH	MATERIAL	DESCRIPTION
1	NICKEL	BRASS	BODY
1	NATURAL	DELFIN	INSULATOR
1	GOLD	PHOS. BRONZE	CONTACT PIN

APPROVALS	DATE
DRAWN G.R.S.	01/07/04
CHECKED	
ISSUED	
SHEET 1 OF 1	

PART DESCRIPTION	PART NO.
BNC FEMALE TO FEMALE ADAPTER	112446
	75ohm

CAD FILE	DWG. NO.	REV.	SIZE	SCALE
C:/112/112446.DWG	112446.DWG	A	A	NA

TOLERANCES FOR MILLIMETERS ARE:		TOLERANCES FOR INCHES ARE:	
0.5 - 8mm	± 0.20mm	.020 - .315	± 0.007"
8 - 30mm	± 0.40mm	.315 - 1.180	± 0.015"
30 - 120mm	± 0.50mm	1.180 - 4.724	± 0.020"

UNLESS OTHERWISE SPECIFIED DIMENSIONS ARE IN MILLIMETERS. DIMENSIONS IN [] ARE IN INCHES AND FOR CUSTOMER REFERENCE ONLY.
 UNLESS OTHERWISE SPECIFIED TOLERANCES FOR MILLIMETERS ARE:
 UNLESS OTHERWISE SPECIFIED DIMENSIONS ARE IN MILLIMETERS. DIMENSIONS IN [] ARE IN INCHES AND FOR CUSTOMER REFERENCE ONLY.
 UNLESS OTHERWISE SPECIFIED TOLERANCES FOR INCHES ARE:

Amphenol **Connex**