



**HESTORE.HU**

elektronikai alkatrész áruház

**EN:** This Datasheet is presented by the manufacturer.

Please visit our website for pricing and availability at [www.hestore.hu](http://www.hestore.hu).

# MBES15x-5,08-V euroclamp

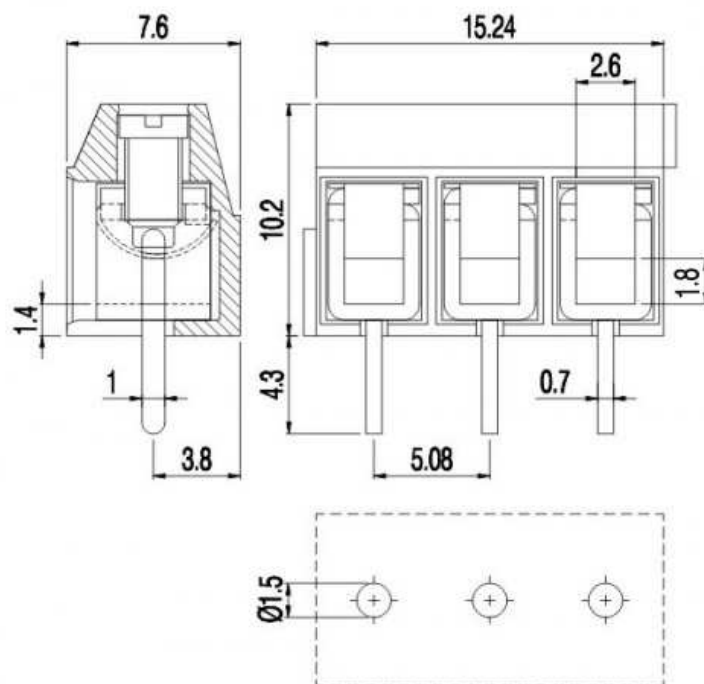

## Single-deck terminal block - Modular version - Pitch 5,08mm - 2÷4 poles

### GENERAL INFORMATION

pitch:	5,08 mm
housing height:	10,20 mm
housing depth:	7.6 mm
dimensional class:	slow
wire section:	2.5 mm <sup>2</sup> / 14 AWG
clamp opening size:	2.6 × 2 mm
wire stripping:	max 7 mm
operating temperature:	-40°C ÷ +130°C

### ELECTRICAL CHARACTERISTICS

current:	24A
voltage:	250V
test voltage:	2 kVrms/60s

### MECHANICAL CHARACTERISTICS

screw:	M2.5
max. torque:	0.4 Nm / 3.6 in.lbs

### APPROVALS DATA



EN 60998-1

current:	17.5A
voltage:	250V
wire section:	1.5mm <sup>2</sup>
torque:	0.4Nm
FILE:	EP151



EN 60998-1

24A
250V
2.5mm <sup>2</sup>
0.4Nm
40019705



UL 1059

20A factory / 15A field
300V
14÷30AWG
3.6Lb-in
E178356

### MATERIALS

housing:	PA - UL 94 V0
----------	---------------

### AVAILABLE COLOURS

screw:  
clamp/spring:  
terminal:

Galvanized steel  
Tin-plated copper alloy  
Tin-plated copper alloy

**GN**<sup>(STD)</sup> **GY** **BK** **BL** **RD** **YL** **OG**

other colours:

upon request

poles	P/N	pcs/pack	W [Kg]*	W [Kg]*
2	MBES152-5,08-V	N/A	N/A	N/A
3	MBES153-5,08-V	N/A	N/A	N/A
4	MBES154-5,08-V	N/A	N/A	N/A