



HESTORE.HU

elektronikai alkatrész áruház

EN: This Datasheet is presented by the manufacturer.

Please visit our website for pricing and availability at www.hestore.hu.

MBES15x-5,08-V euroclamp

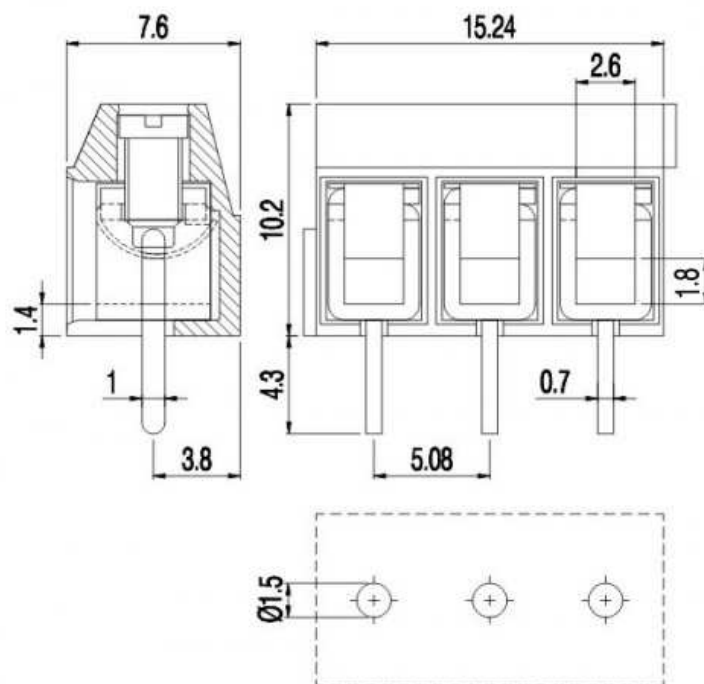

Single-deck terminal block - Modular version - Pitch 5,08mm - 2÷4 poles

GENERAL INFORMATION

pitch:	5,08 mm
housing height:	10,20 mm
housing depth:	7.6 mm
dimensional class:	slow
wire section:	2.5 mm ² / 14 AWG
clamp opening size:	2.6 × 2 mm
wire stripping:	max 7 mm
operating temperature:	-40°C ÷ +130°C

ELECTRICAL CHARACTERISTICS

current:	24A
voltage:	250V
test voltage:	2 kVrms/60s

MECHANICAL CHARACTERISTICS

screw:	M2.5
max. torque:	0.4 Nm / 3.6 in.lbs

APPROVALS DATA



EN 60998-1

current:	17.5A
voltage:	250V
wire section:	1.5mm ²
torque:	0.4Nm
FILE:	EP151



EN 60998-1

current:	24A
voltage:	250V
wire section:	2.5mm ²
torque:	0.4Nm
FILE:	40019705



UL 1059

current:	20A factory / 15A field
voltage:	300V
wire section:	14÷30AWG
torque:	3.6Lb-in
FILE:	E178356

MATERIALS

housing:	PA - UL 94 V0
----------	---------------

AVAILABLE COLOURS

screw:
clamp/spring:
terminal:

Galvanized steel
Tin-plated copper alloy
Tin-plated copper alloy

GN^(STD) **GY** **BK** **BL** **RD** **YL** **OG**

other colours:

upon request

poles	P/N	pcs/pack	W [Kg]*	W [Kg]*
2	MBES152-5,08-V	N/A	N/A	N/A
3	MBES153-5,08-V	N/A	N/A	N/A
4	MBES154-5,08-V	N/A	N/A	N/A