



**HESTORE.HU**

elektronikai alkatrész áruház

**EN:** This Datasheet is presented by the manufacturer.

Please visit our website for pricing and availability at [www.hestore.hu](http://www.hestore.hu).

Part Number:

386

Type	Size	Rating	Description
Incandescent	T6	14V 80mA	T-1 <sup>3</sup> / <sub>4</sub> Midget Groove Lamp

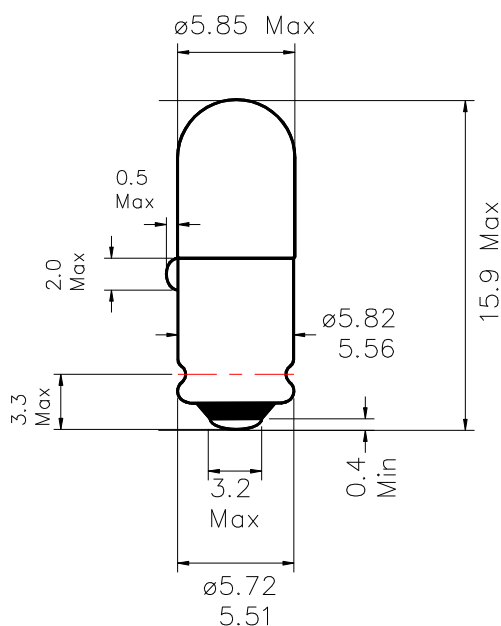

Dimensions in millimetres

TEST VOLTS	CURRENT (mA)			LIGHT OUTPUT (Lm)			LIFE Hours
	Min.	Nom.	Max.	Min.	Nom.	Max.	
14	72	80	88	2.8	3.8	4.8	15,000

Notes:

- |   |                |   |
|---|----------------|---|
| 1 | Base Type      | Nickel plated S5.7s base in accordance with BS EN 60061-1 |
| 2 | Filament Shape | C-2F  |
| 3 | Lamp Marking   | CML386 14V 80mA or 14V 80mA                               |
| 4 | Environmental  | RoHS & REACH SVHC compliant                               |