



HESTORE.HU

elektronikai alkatrész áruház

EN: This Datasheet is presented by the manufacturer.

Please visit our website for pricing and availability at www.hestore.hu.

2.30" (60.20mm) Φ 5.00mm 8*8 Single Color Dot Matrix Displays

Features:

- *High dot intensity
- *Wide viewing angle
- *Range of colors
- *Black face white dot
- *RoHS compliant

Available option:

- *Alternative face and segment color
- *Cropped terminal pins
- *Available emitting color
- *Low current version

Electro/Optical Characteristics $I_f=20\text{mA}$ $T_a=25^\circ\text{C}$

Part Number Row Cathode Column Anode	Part Number Row Anode Column Cathode	Emitting Color	Peak Wavelength	Forward Voltage V_f /Dot		Luminous Intensity I_v /Dot	
				Typ.	Max.	Min.	Typ.
LM-88R23-C	LM-88R23-CC	GaP/GaP Red	700	2.25	2.50	0.40	0.80
LM-88HR23-C	LM-88HR23-CC	GaAlAs/GaAs SH Hi-Red	660	1.80	2.20	8.00	12.00
LM-88SR23-C	LM-88SR23-CC	GaAlAs/GaAs DH Super Red	660	1.80	2.20	22.00	28.00
LM-88O23-C	LM-88O23-CC	GaAsP/GaP Orange	632	2.10	2.50	8.00	12.00
LM-88Y23-C	LM-88Y23-CC	GaAsP/GaP Yellow	585	2.10	2.50	4.00	7.00
LM-88G23-C	LM-88G23-CC	GaP/GaP Green	568	2.20	2.50	7.00	11.00
Units			nm	V		med	

Maximum Ratings $T_a=25^\circ\text{C}$ (Derate above 25°C)

Characteristic	Test Condition	Symbol	R	HR	SR	O	Y	G	Units
Pulse Forward Current Per Dot	1/101 duty cycle 0.1ms Pulse width	I_{FP}	50	100	100	100	100	100	mA
DC Forward Current Per Dot		I_F	15	25	25	30	30	30	mA
Reverse Current Per Dot	$V_R=5\text{V}$	I_R	10	10	10	10	10	10	μA
Power Dissipation		P_D	40*64	60*64	60*64	80*64	80*64	80*64	mW
Operating Temperature		T_{OPR}	-40 to +80						$^\circ\text{C}$
Storage Temperature		T_{TSG}	-40 to +85						$^\circ\text{C}$
Lead soldering temperature	1.60mm from body maximum 3 seconds		260						$^\circ\text{C}$

2.30" (60.20mm) Φ 5.00mm 8*8 Single Color Dot Matrix Displays

PACKAGE DIMENSION

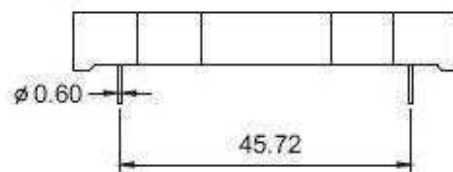
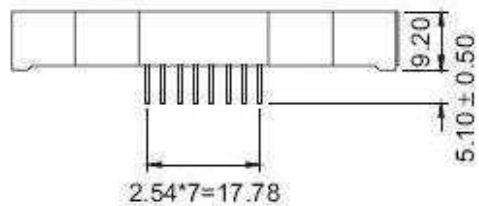
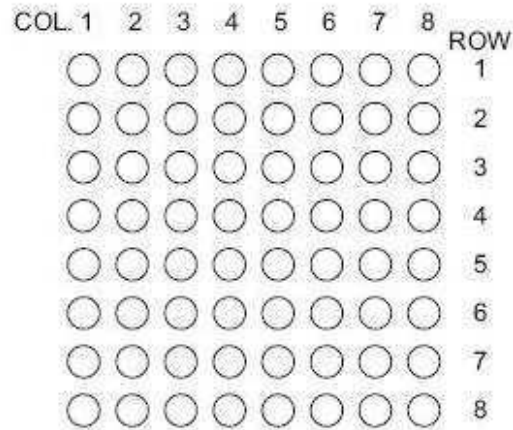
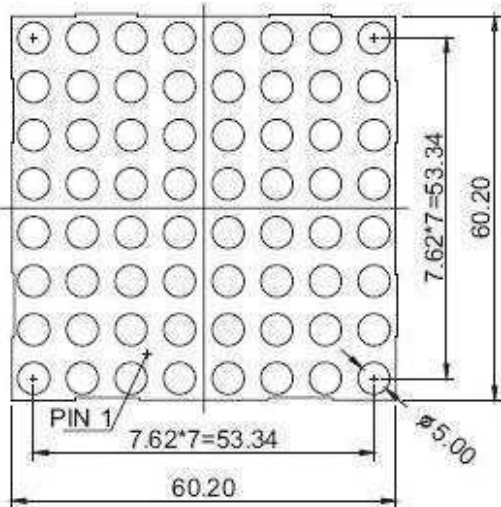

Tolerance $\pm 0.25\text{mm}$ unless stated

INTERNAL CIRCUIT DIAGRAM

Row Cathode
 Column Anode
 LM-88X23-C

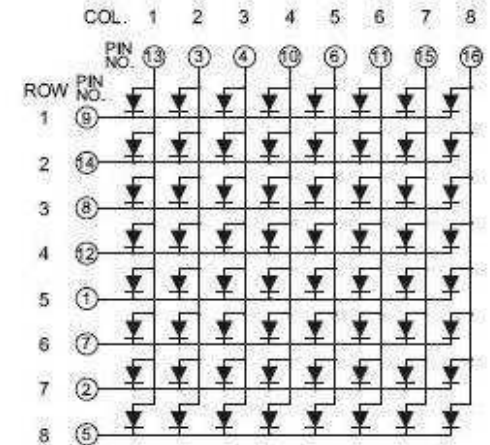

Row Anode
 Column Cathode
 LM-88X23-CC

